

# FrameWork

Freestanding Panel System



Define your space within the ever changing office environment with **FrameWork**, an **IN-STOCK**, commercial grade, quick to install, freestanding modular panel system from **HDL**.

**Simple, durable, and affordable.**

- ✓ Great competitive pricing!
- ✓ Contemporary clean aesthetic
- ✓ Fast and easy to install/reconfigure
- ✓ Large range of sizes
- ✓ Tackable panel surface
- ✓ Built-in raceway for wire management
- ✓ Large range of accessories includes storage and electrical components
- ✓ Sizes co-ordinate with **HDL** and Heartwood Manufacturing Ltd metric furniture (not exclusively)

**Designed to last, and shipped fast.**

When you choose **HDL**, you choose high quality, price sensitive products that are **IN-STOCK** and ready for next day shipping.

Embrace the Heartwood Advantage.

Cover:

**Layout #7** feat. HDL Innovations series in Evening Zen, with Jupiter series Team Mid-back chairs

Below left to right:

**Layout #9** feat. HDL Titan in Hardrock Maple, with 100 series LCD single monitor arm

**Layout #8** feat. HDL Innovations in Sugar Maple, with 100 series LCD dual monitor arm

**Layout #4** feat. HDL Innovations in Autumn Maple





Layout #16 feat. HDL Innovations series storage and laminate work surfaces in Winter Wood, metal loop legs, and Jupiter series Zeus mid-back chairs.







## FrameWork panels build your workspace solution.

Mix-and-match **FrameWork** panels. Available in a multitude of widths with 48" and 66" tall options.

1. Powder coated 2 3/8" extruded aluminum frame
2. Fabric exterior over an engineered wood block panel
3. Tackable and noise absorbing EVA foam panel (above work surface only)
4. 2 easy to adjust levels included per panel
5. 1 grommet on 24" wide panels, 2 on wider panels
6. Optional phone/internet or power into grommet

### ✓ 48" Tall Panel Available in 5 sizes

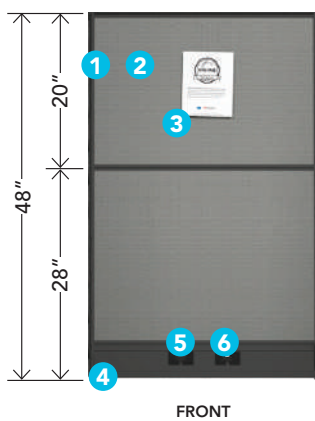

### ✓ 66" Tall Panel Available in 8 sizes

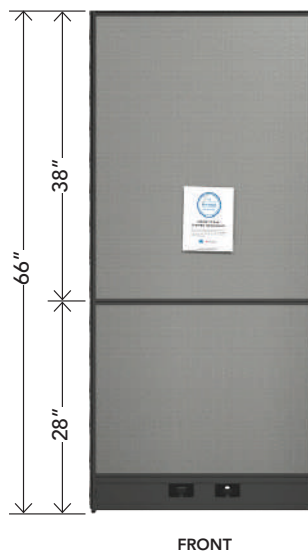

### ✓ 66" Tall Clear Glaze Panel Available in 3 sizes

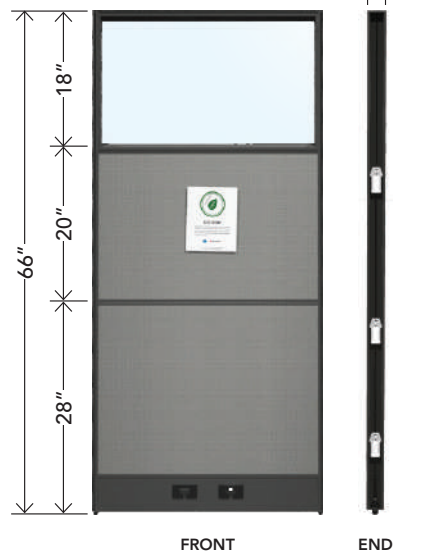



**Layout #9** feat. HDL Titan furniture in Hardrock Maple, with 100 series LCD single monitor arm

Left:

**Layout #3** (x2) feat. HDL Innovations furniture in Royal Mahogany, with Jupiter series Teem Mid-back chairs and 100 series LCD dual monitor arms

## FastClip easy-to-assemble panel to post system for fastest install in the industry.

Panel male connector  
Post female connector

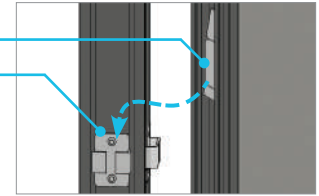

- Easy to connect multiple height panels and posts
- Preinstalled clips on panels and posts
- Creates a secure stable connection

## Connecting posts support your desired configuration.

4 different **FrameWork** posts, all available in 48" and 66" high options.

✓ **Square 2 Way Post**  
To create an 'L' shape

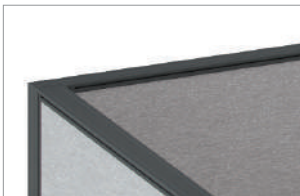

✓ **Square 3 Way Post**  
To create a 'T' shape



✓ **Square 4 Way Post**  
To create an 'X' shape



✓ **Triangle 3 Way Post**  
To create a 'Y' shape



## Work Surface Mounting Kits for panel hung laminate desking installations

Laminate work surface  
Mounting bracket  
Mounting screws

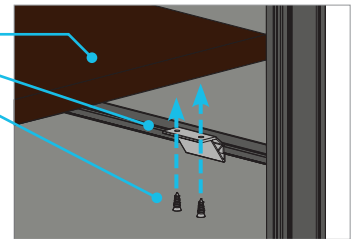

- Modern open concept desking alternative
- Combine laminate surfaces with **HDL** metal leg options
- Compatible with INNOVATIONS Series laminate tops
- Clips include mounting screws
- Creates a secure stable worksurface

## Plexiglass panel extensions

- 10" high panel extension
- Can be installed on 48" or 66" panels
- Two bracket finishes
- Frosted plexiglass finish



## Built-in wire management raceway to contain and clean up the clutter.

- Wire management in the bottom of all panels
- Easy to open bottom cover and side aluminum profile
- Various optional electrical components available

## Panel hung storage maximizes your work space.

**FrameWork** has 2 panel hung storage options that fit onto 30 and 36" panels only.

1. Adjustable height powder coated steel cabinet
2. Adjustable height 1" melamine shelf



Layout #5 feat. HDL Innovations  
in Evening Zen

## Sample layouts. Ideas of how to shape your space.

For flexibility, choose **FrameWork**. Select from a layout below or create your own.

- ✓ Wrap around free standing desks
- ✓ Define borders within a room
- ✓ Team with **HDL** and Heartwood or use with any existing freestanding furniture



1



2



3



4



5



6



7



8



9



10



11



11 combined with  
Heartwood 850 series



**IN-STOCK components** can create a private haven in the open office landscape.

**FrameWork's** various modular components can be configured to create a variety of functional settings to suit your environment.

- The component list is current at time of print
- Check online at [heartwooddl.com/series/26/framework](http://heartwooddl.com/series/26/framework) for up to date information



**FrameWork Layout #11** combined with Heartwood Manufacturing 850 series Layout #14 in Grey Dusk and Pure White



**48" Tall Panel**  
5 sizes from 24 - 48" wide

**66" Tall Panel**  
8 sizes from 24 - 72" wide

**66" Tall Clear Glazed Panel**  
3 sizes from 24 - 36" wide



**Square Connecting Posts**

**Triangle Connecting Post**

**Panel End Trim**

**10" High Plexiglass Panel Extensions**  
5 sizes for 24 - 48" wide panels



**Freestanding Panel Base Set**

**Panel Connecting Kit**

**Flush Wall Mount Bracket Set**



**Gable Bracket Set**

**Work Surface Mounting Kit**

**Overhead Shelf Set**



**Overhead Storage Cabinet**

**Electrical Jumper**

**15 Amp Power Cord**



**Electrical Y Connector**

**Power Block with Mounting Bracket**

**Duplex Receptacle**

**CAT 6 Jack Kit**

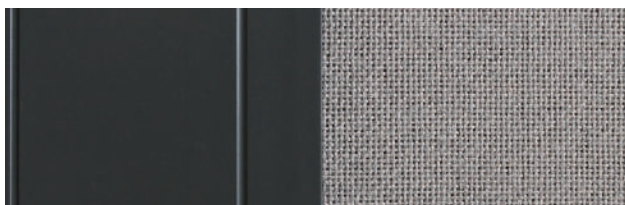

**Charcoal**

**Grey**

**FrameWork neutral finishes match any office interior.**

- Charcoal colour powder coated frames/posts/storage
- Commercial grade 100% polypropylene woven grey fabric panels
- Custom fabrics are available with adequate volume and lead time

## Select **HDL** FrameWork series, and embrace the Heartwood Advantage.

- ✓ Knowledgeable customer service reps
- ✓ On time delivery
- ✓ Additional packaging and care is taken to eliminate freight damage
- ✓ Satisfaction guaranteed
- ✓ View stock levels online
- ✓ Limited **LIFETIME** Warranty

HDL is pleased to offer a limited lifetime warranty on all laminate products. For specific series warranty details, please refer to the downloadable Limited Lifetime Warranty document online.



- ✓ The **IN-STOCK** Advantage

HDL is committed to maintaining stock at all times. Every effort will be made to ensure these products are available.



- ✓ **ECO** Story

HDL is committed to supplying office furniture products in an environmentally responsible manner. We are proud to partner with like-minded corporate citizens who align environmental stewardship with their company's core values and goals.



### Heartwood Distributors Ltd.

Choose high quality, price sensitive products that are **IN-STOCK** and ready for next day shipping.

[www.heartwooddl.com](http://www.heartwooddl.com)

A 251 Adams Rd, Kelowna, BC V1X 7R1  
T 1 800 567 3060  
F 250 765 1213

Contact your local dealer:

PRINTED IN CANADA

