

Meet CellPod

An architectural room system



SENATOR

Powered by Privacy

Isolation isn't about being alone but about having the personal acoustic and visual privacy to get your task done.

We've all embraced hybrid working and the transition to online meetings for offsite co-workers, as well as, clients, suppliers.

CellPod offers exceptional acoustic privacy empowering users to talk more freely in the comfort that they won't be heard but also that they won't disrupt their co-workers.



Your Possibilities are Endless

Phone Calls

Video Conference

Solo work

Training

Collaborative Teams



Telephone Booth
One person



Study Booth
One person

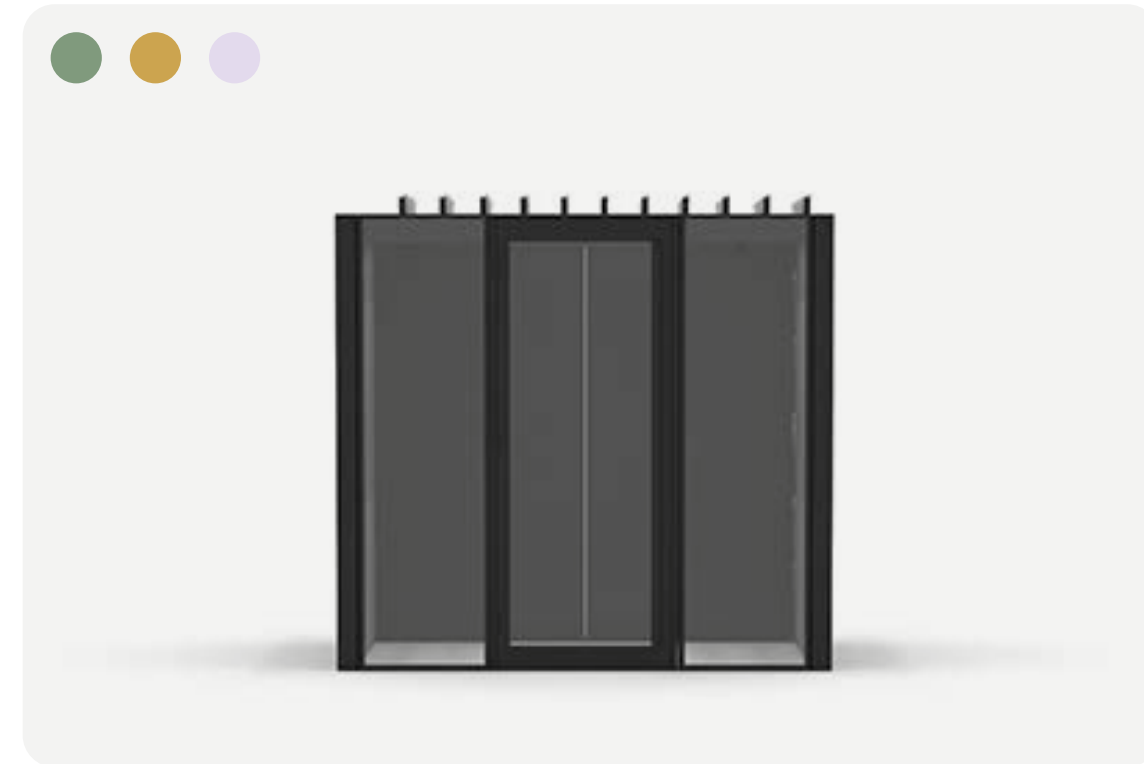

Focus Pod
Suitable for two people



Impromptu Meeting Room with Portico
Suitable for four people



Small Meeting Room
Suitable for four people



Medium Meeting Room
Suitable for six people

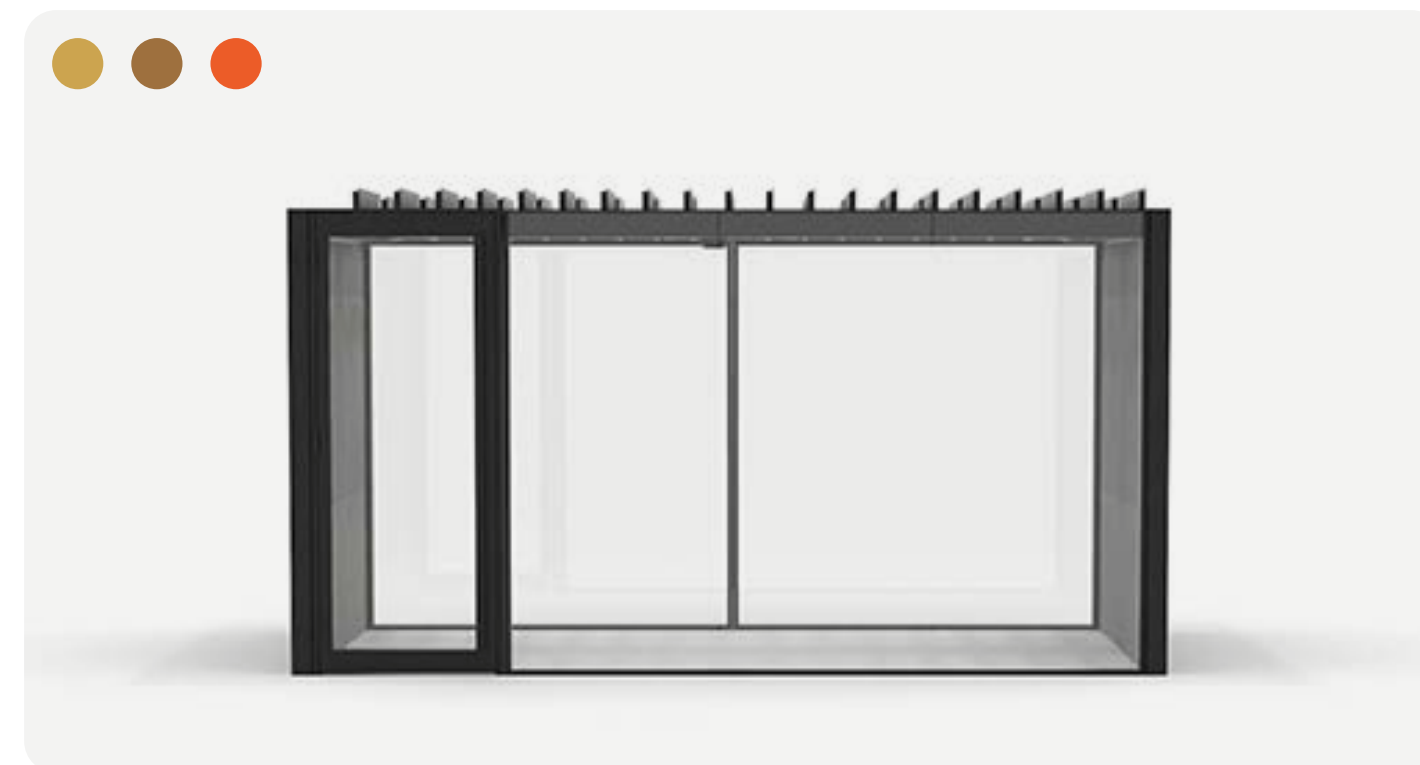

Large Meeting Room
Suitable for eight people



XL Meeting Room
Suitable for 12 people

Meet CellPod:

- CellPod incorporating an Active Roof System, integrated dry wipe panels and a frameless glass panel corner detail.
- CellPod provides a great solution for a team collaboration and meeting space and can be situated immediately adjacent to other workspaces.



Meet CellPod:

- The addition of the Portico on the outside wall of a CellPod helps define the space creating an additional collaboration space.
- CellPod incorporating a media screen allowing users to share content and collaborate. Integrated dry wipe panels a frameless glass panel corner detail.



Meet CellPod:

CellPod can be configured to create large stand alone conference rooms with integrated media displays and dry wipe panels providing both formal and informal spaces for up to 12 people.



Architectural Features:



Intuitive Design

CellPod at it's core is made by from extruded Aluminum channels that allow for endless options of colors, finishes, and specifications.



Custom to you

The interior design can specified to your requirements from drywipe, pinable or AV for conferencing.



Form and function

The 1/2" acoustic grade laminated glass sit in the aluminum frame to create a frameless glass panel corner detail.



Frameless Ecofon System



Utilize CellPod's exterior to maximize the possibilities in your workspace with a Portico.

Our Active Ceiling System

Our patented (No.GB1718165.2) Active Ceiling System can be specified which complies with many international building safety codes in eliminating the need for fire suppression systems to be integrated directly into the roof of the Pod.



One Person Pod

Escape the office and find a room of solitude for a quick call or the need to focus on writing that important email.

The Study Booth Pod can meet ADA standards to ensure accessible design for users with disabilities.



Telephone Booth

Width: 3'9"
Depth: 3'9"
Height: 7'5"



Study Booth

Width: 5"
Depth: 3'9"
Height: 7'5"

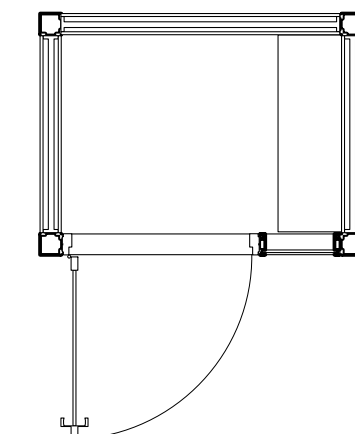
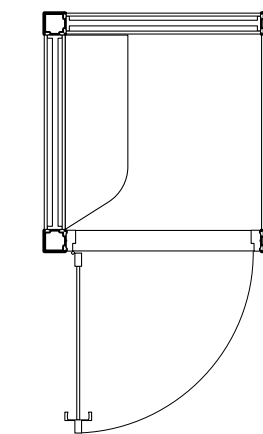
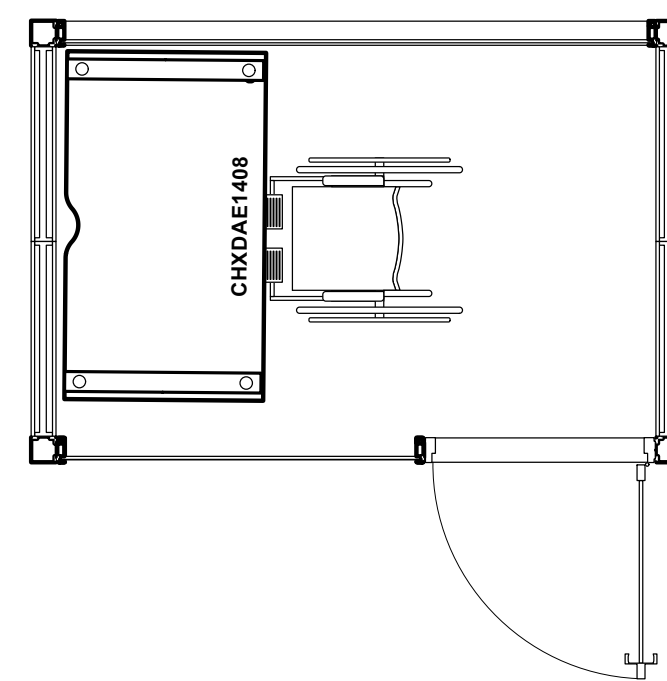

Two Person Pod

Our two person Pods have the flexibility to easily accommodate two or act as an individual hybrid Pod for nomadic workers.

Dimensions:

Width: 8'1"
Depth: 6'1"
Height: 7'5"

For full specifications go to pg. 21



Example One:

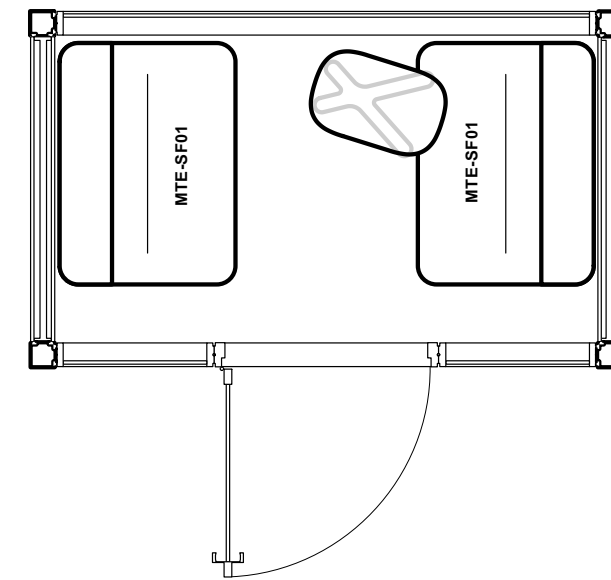

Example Two:

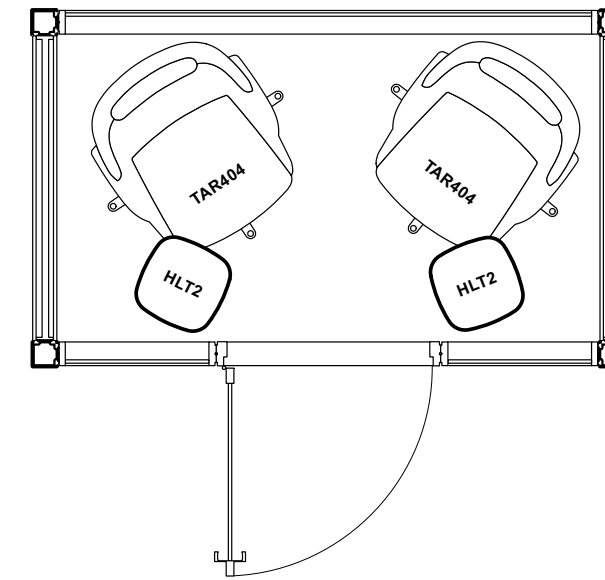

Example Three:

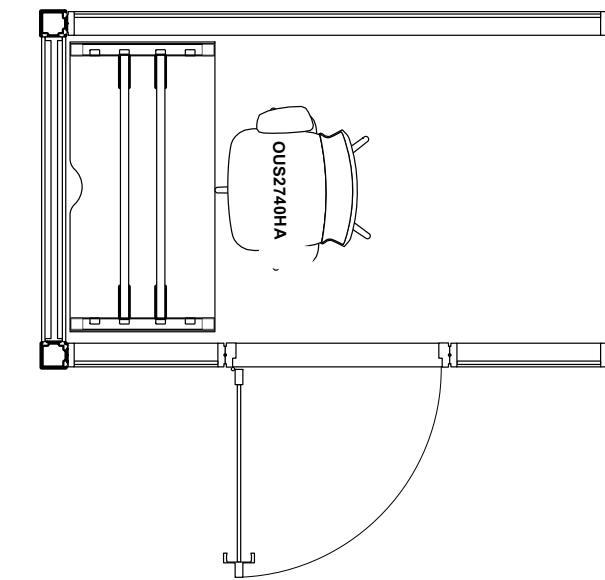

Example Four:

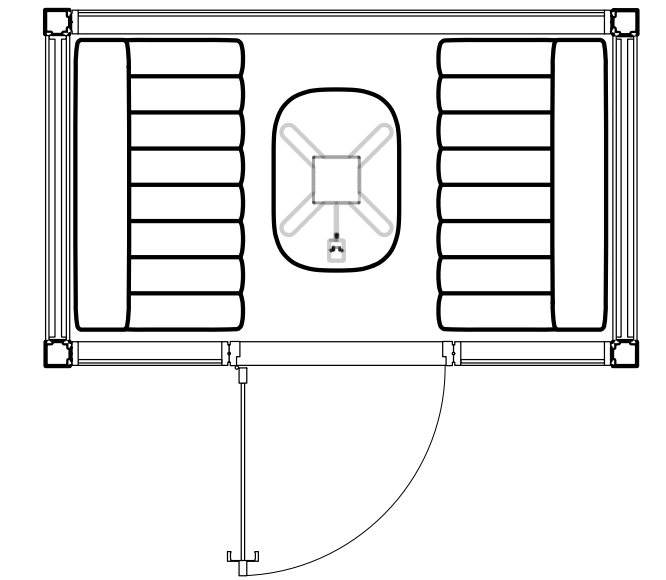

Small meeting Room

Four person Pods offer a more practical and multi-use solution to accommodate an array of furniture to easily tailor this Pod to your needs.

This Pod can easily be equipped with video conferencing technology – so you can stay in touch with your entire team wherever they are.

Dimensions:

Width: 10'
Depth: 10'
Height: 7'5"

For full specifications go to pg. 23



Example One:

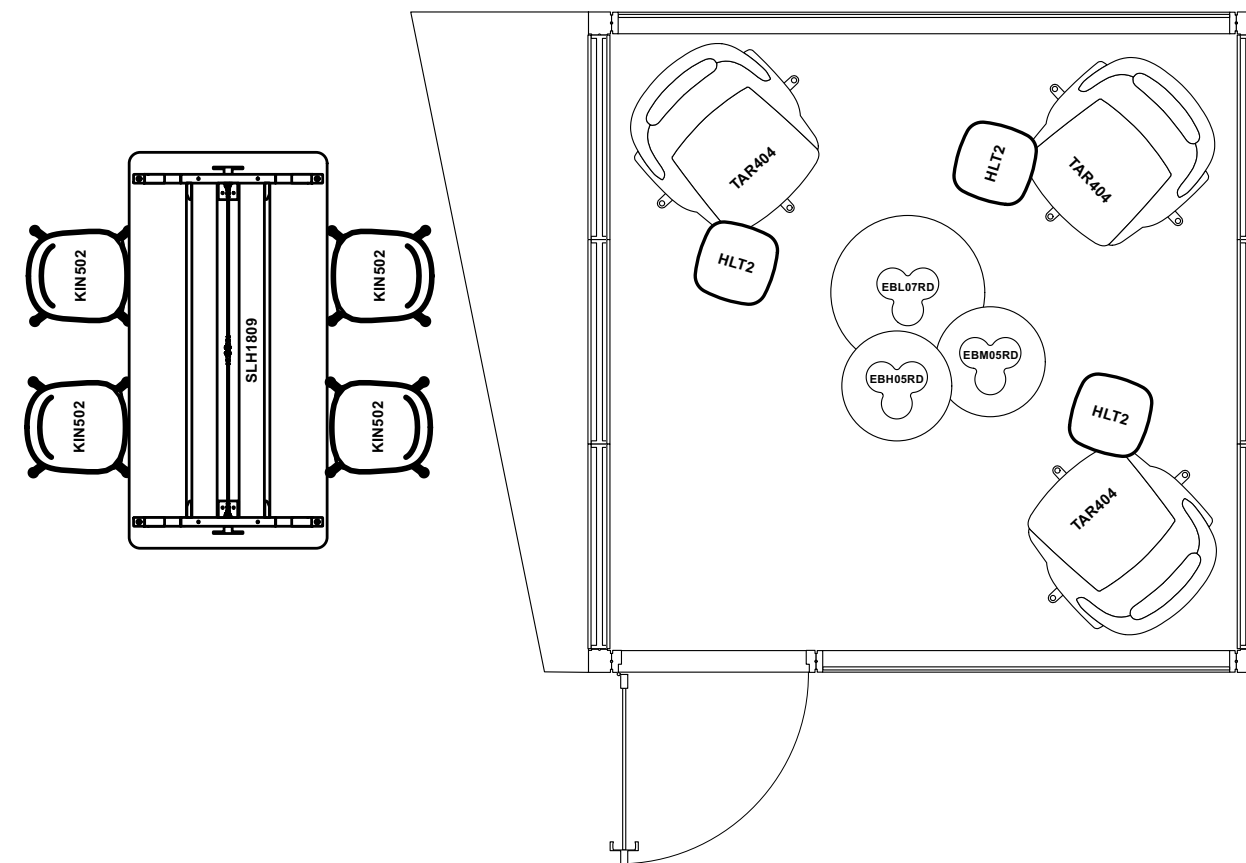

Example Two:

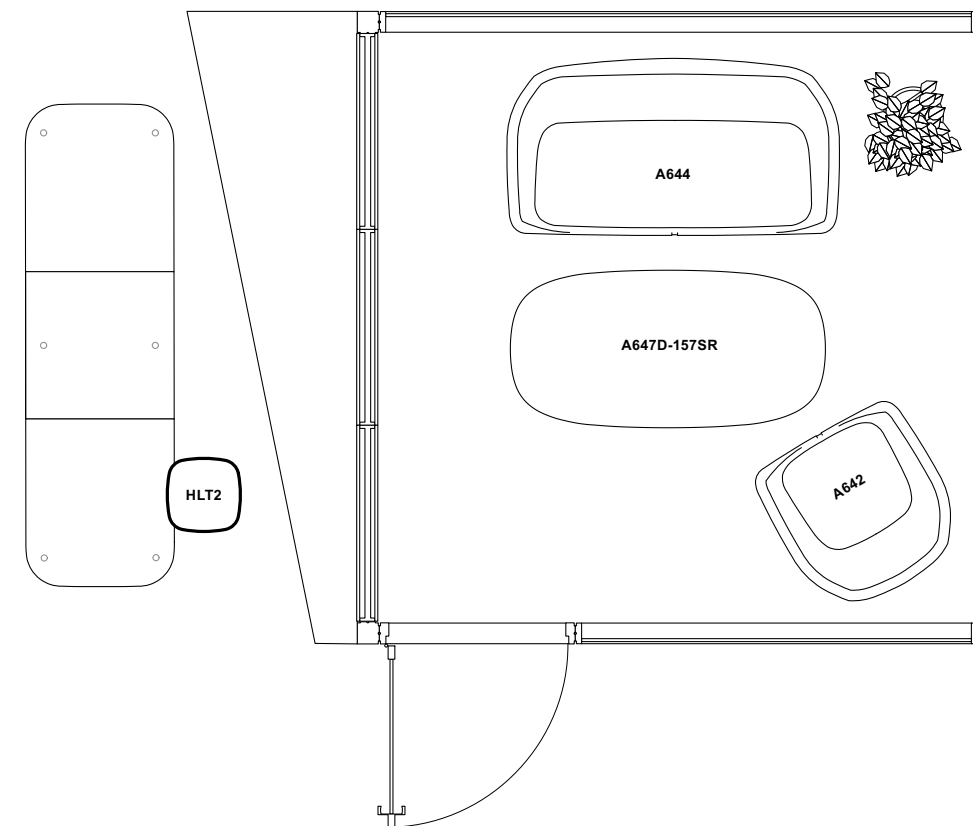

Example Three:

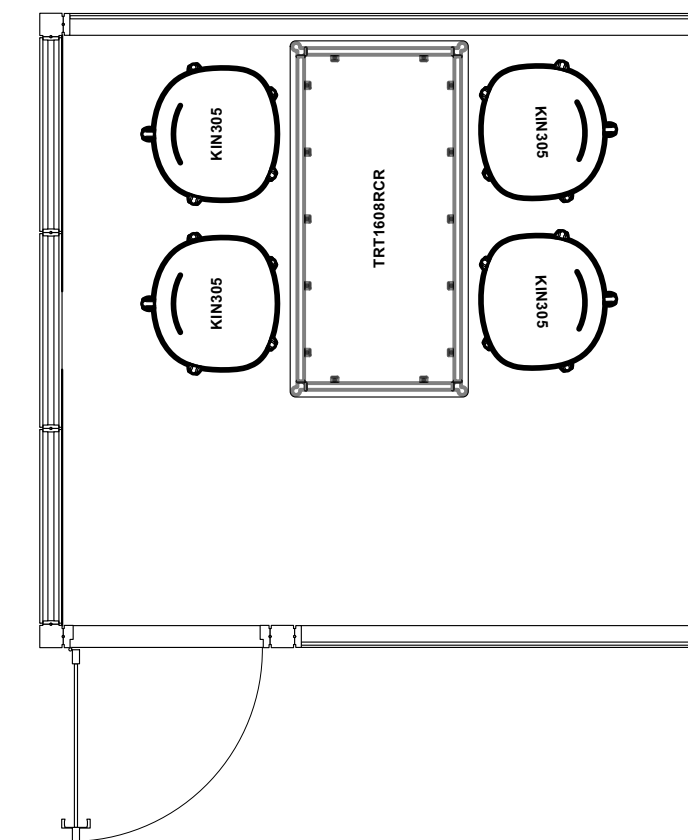

Example Four:

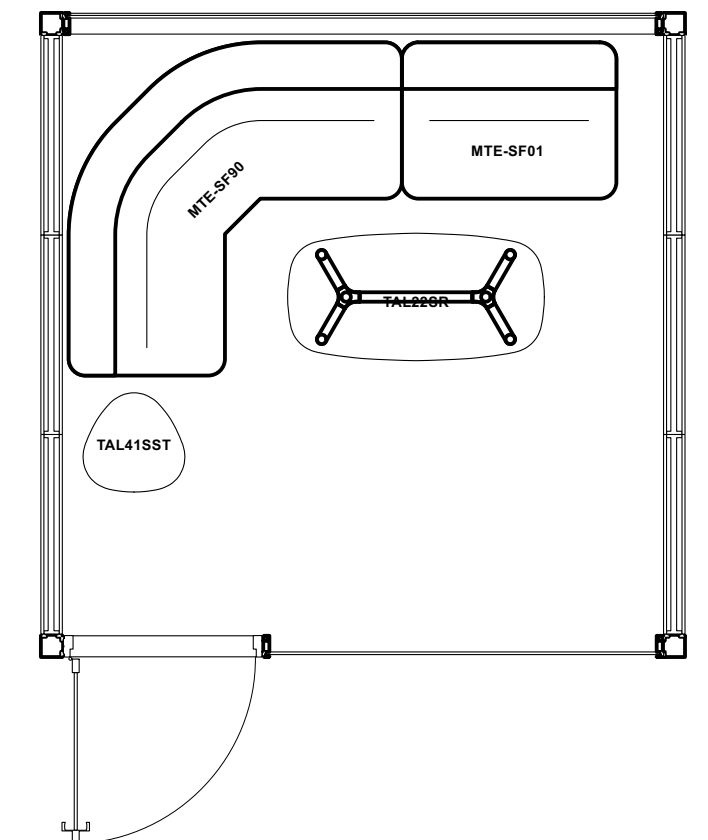

Six Person Rectangular Pod

Designed for up to six people, this meeting room is the ideal place to co-create, brainstorm and meet together – without disturbing the office.

This Pod can easily be equipped with video conferencing technology – so you can stay in touch with your entire team wherever they are.

Dimensions:

Width: 14'

Depth: 10'

Height: 7'5"

For full specifications go to pg. 21

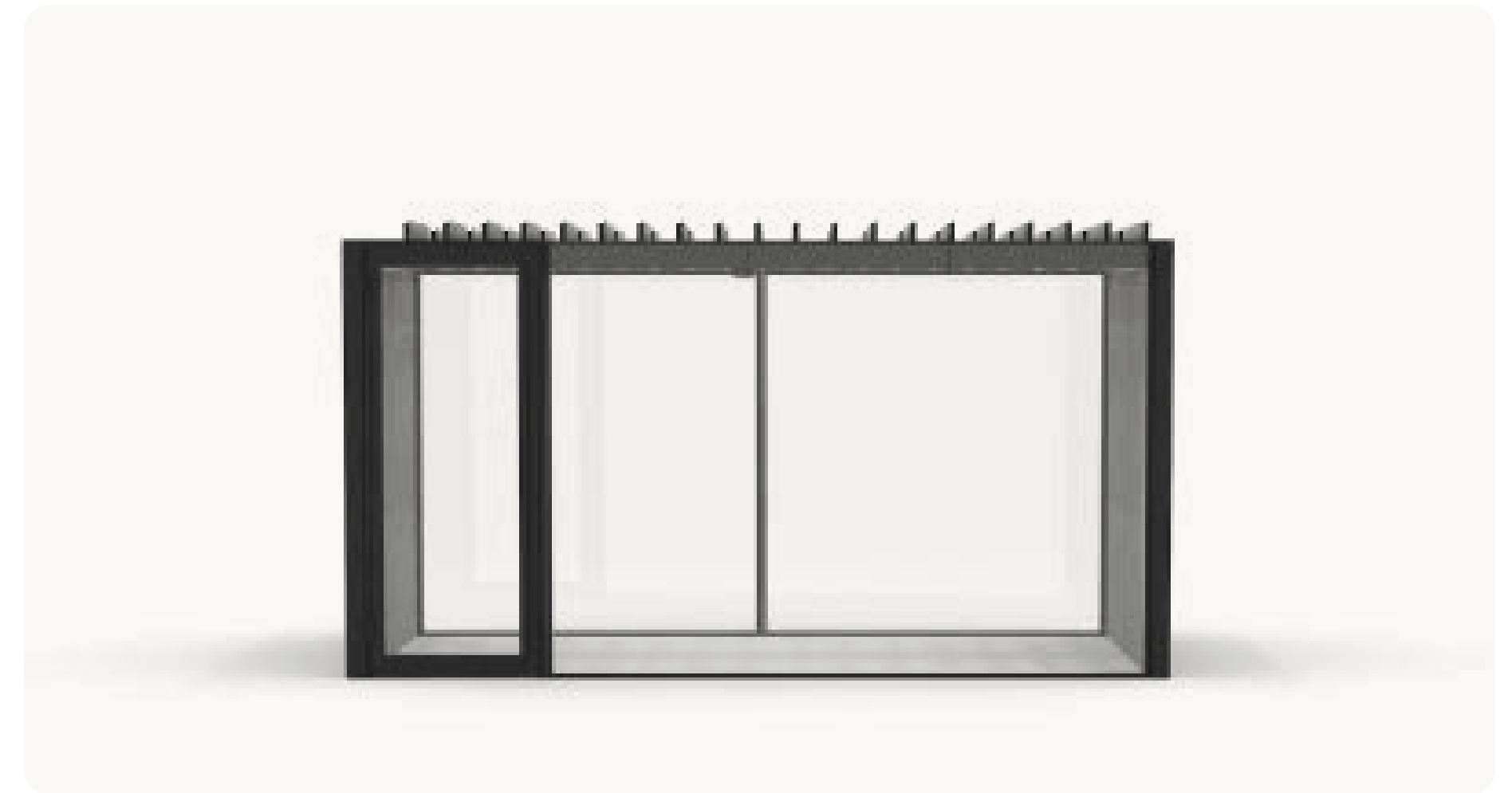

Example One:

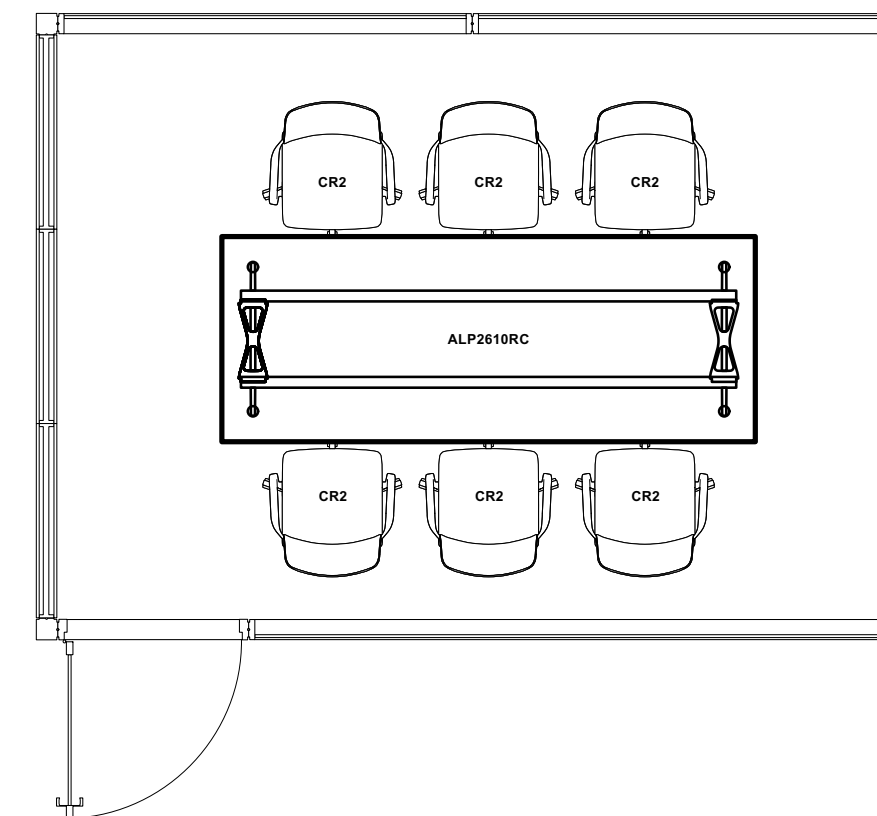

Example Two:

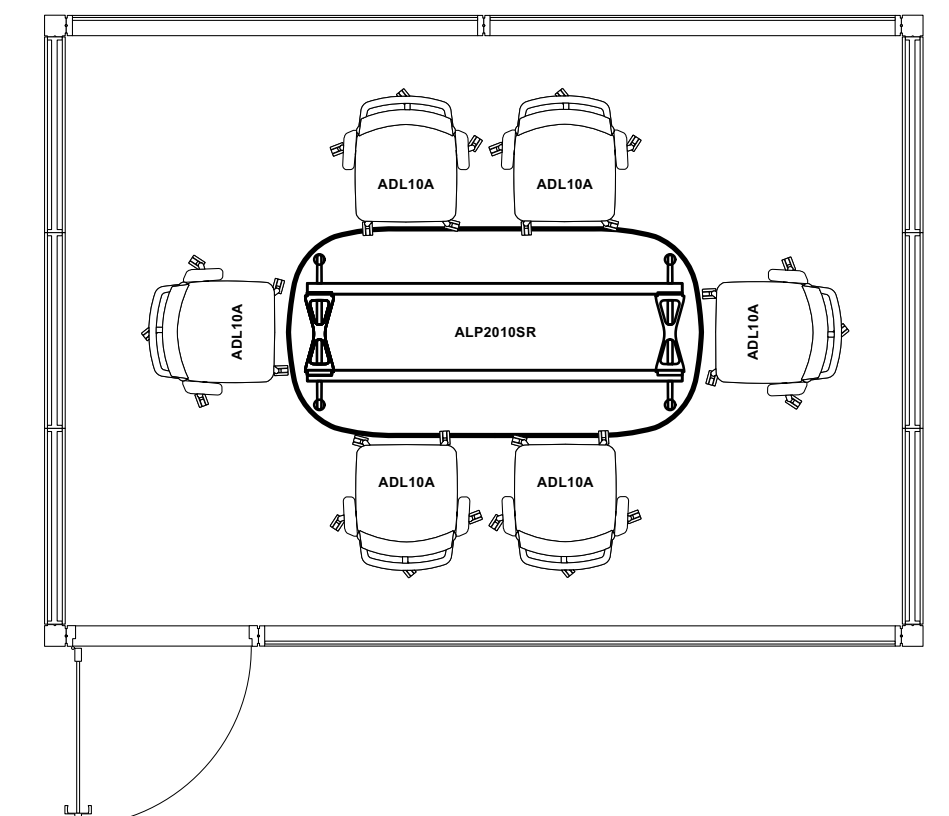

Six Person Square Pod

Just like the rectangular six person Pod this Pod is designed for upto six people, this meeting room is the ideal place to co-create, brainstorm and meet together – without disturbing the office.

This Pod can easily be equipped with video conferencing technology – so you can stay in touch with your entire team wherever they are.

Dimensions:

Width: 10'
Depth: 10'
Height: 7'5"

For full specifications go to pg. 24



Example One:

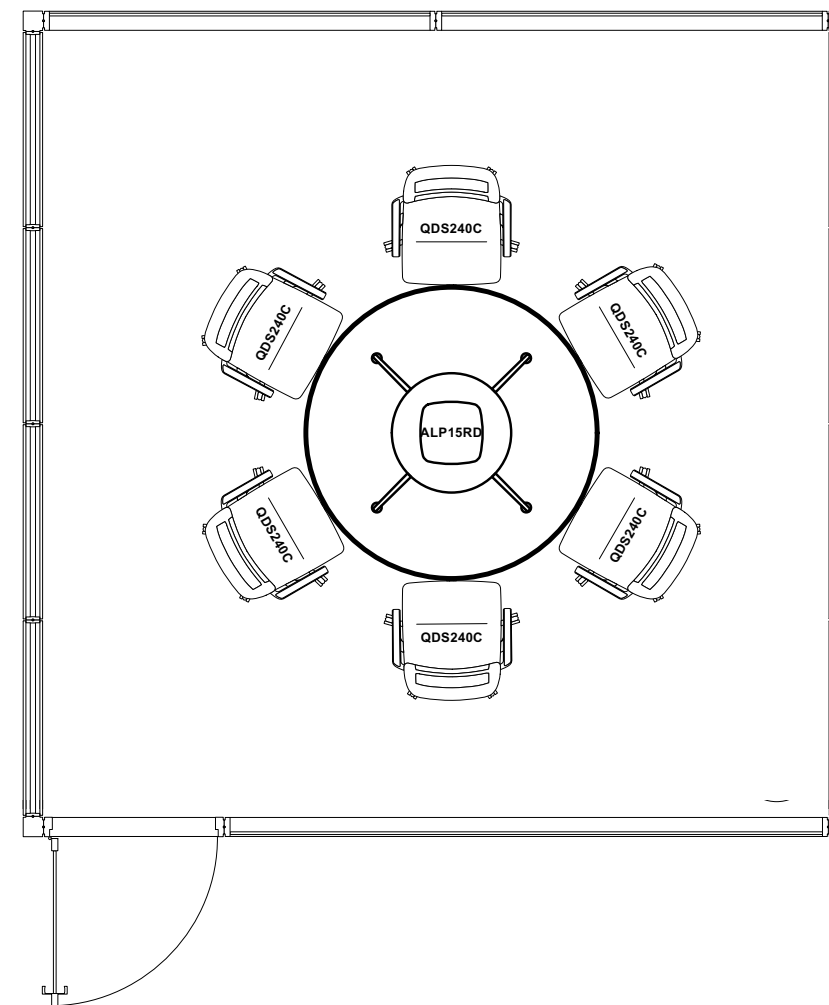

Example Two:

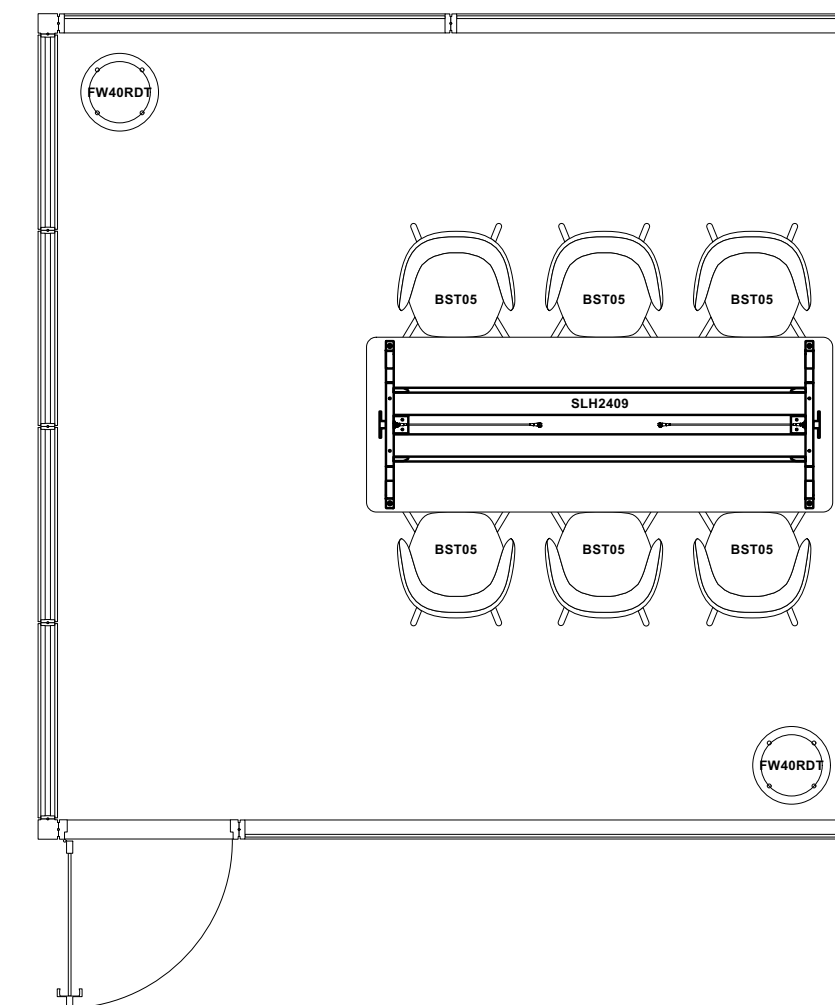

Example Three:

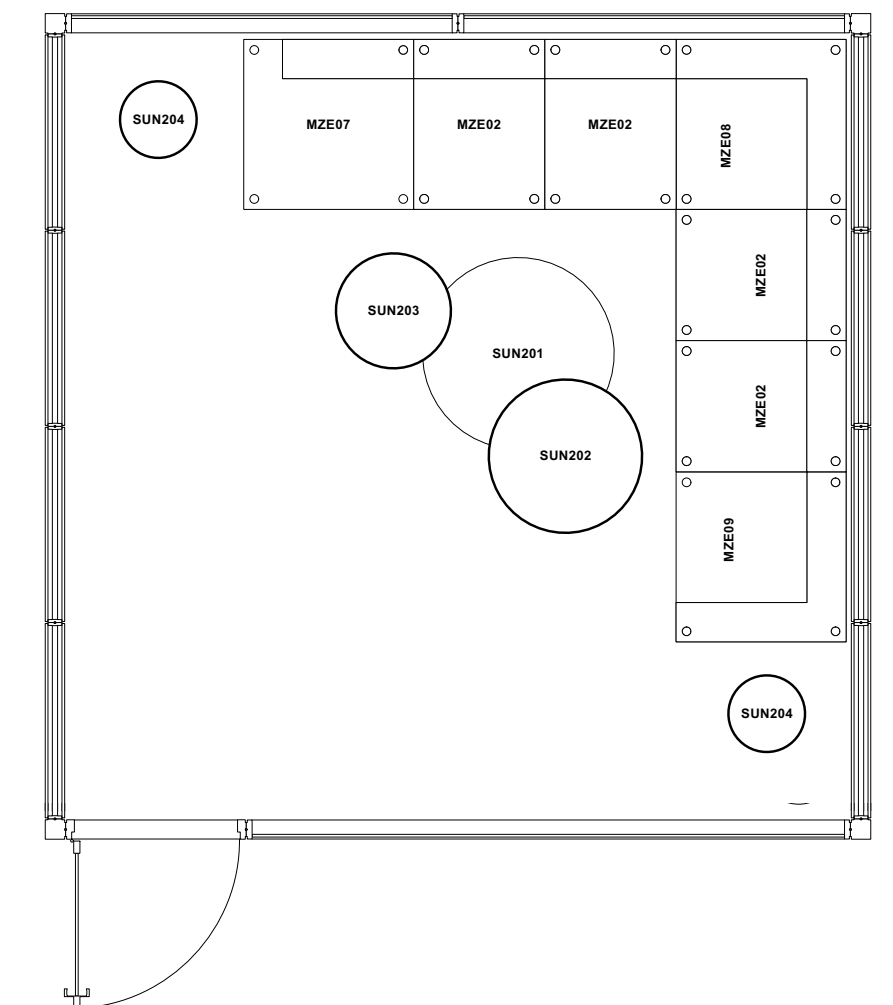

Twelve Person Pod

Your office within an office, this extra large twelve person Pod allows users to instantly add create spaces that are private and most importantly quiet.

Comfortably accommodating up to twelve people this Pod acts as an elegant boardroom to a luxurious escape from the day to day.

Every Pod can easily be equipped with video conferencing technology – so you can stay in touch with your entire team wherever they are.

Dimensions:

Width: 19'10"

Depth: 14'

Height: 7'5"

For full specifications go to pg. 26



Example One:

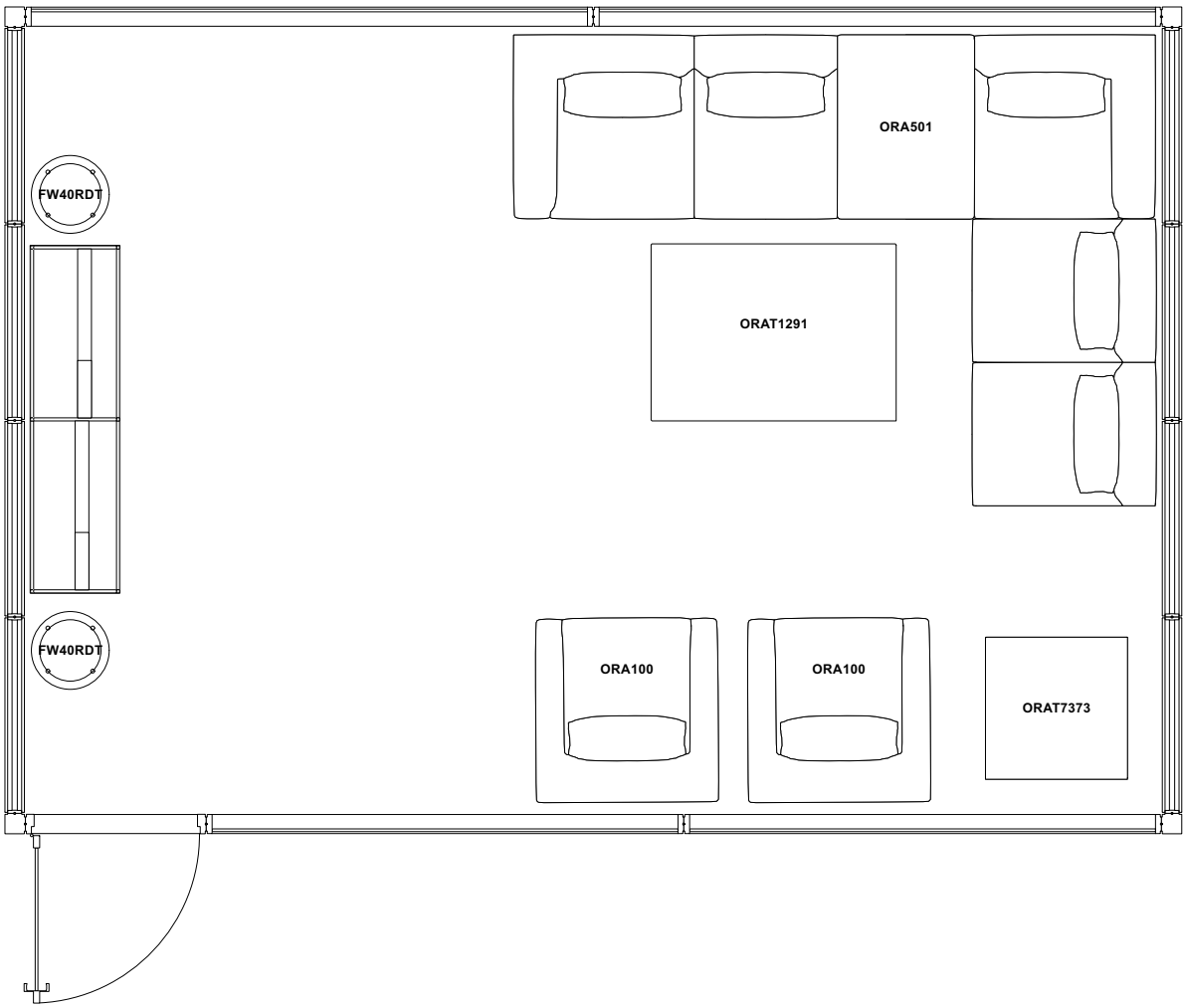

Example Two:

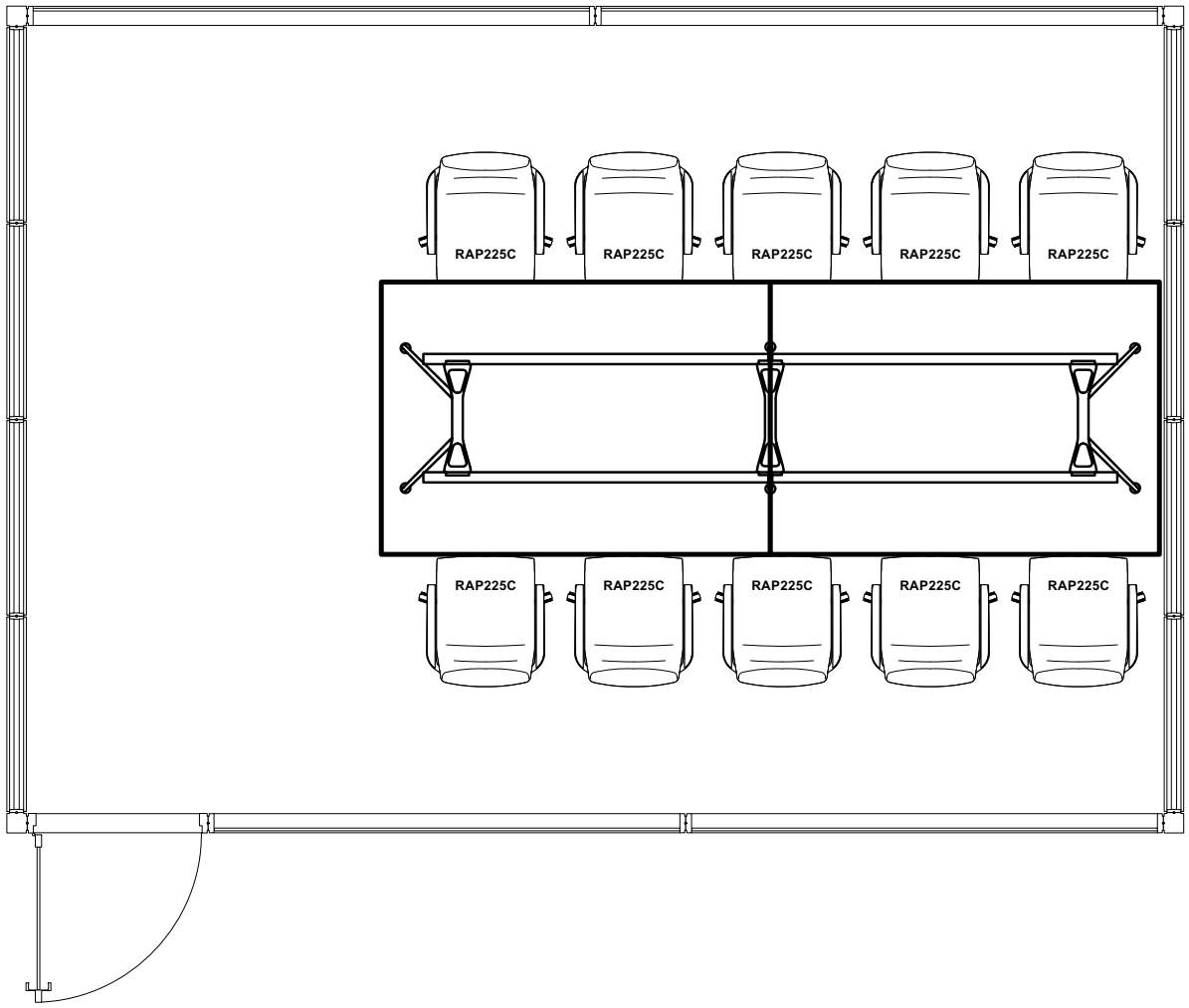

Why acoustics matter

As the design of the workplace has moved to a more open landscape and the hybrid workstyles CellPod has the power to blend onsite with offsite users in acoustic privacy.

CellPods offer the ideal solution for a quick call, focused work, or a productive meeting. CellPod is a favourable solution to the traditional huddle and conference with configurations to suit every possible requirement.

This is important as visual and acoustic noise are key factors the way we all work.

99%

Of employees claim their level of focus decreases drastically due to office noises.

SP Banbury, DC Berry (2005).
U.S. National Library of Medicine

Testing, testing, testing, 1, 2, 3...

CellPod uses the latest innovations to achieve exceptional acoustics that are well above industry standard.

For example: When inside CellPod the perceived ambient noise omitted is reduced by over 90%.

These test results are according to EN ISO 354. Classification according to EN ISO 11654, and the single value ratings for Noise Reduction Coefficient, NRC and Sound Absorption Average, SAA according to ASTM C 423.

-35 (db)

Measured in deciBels (db).
Typical sound absorption values are:
½" acoustic laminated glass 35(db)
Fabric panel (with barrier) 35(db).

A Breath of Fresh Air

CellPods are stand-alone units and do not need integrating into a building's M&E infrastructure. As standard all pods are provided with an air handling system that refreshes the air within the pod maintaining a healthy environment with the air being drawn and returned to the wider building environment...

Each pod is specified with fans capable of changing the air internally to comply with regional standards at a minimum rate of 40Yds² per hour per person.

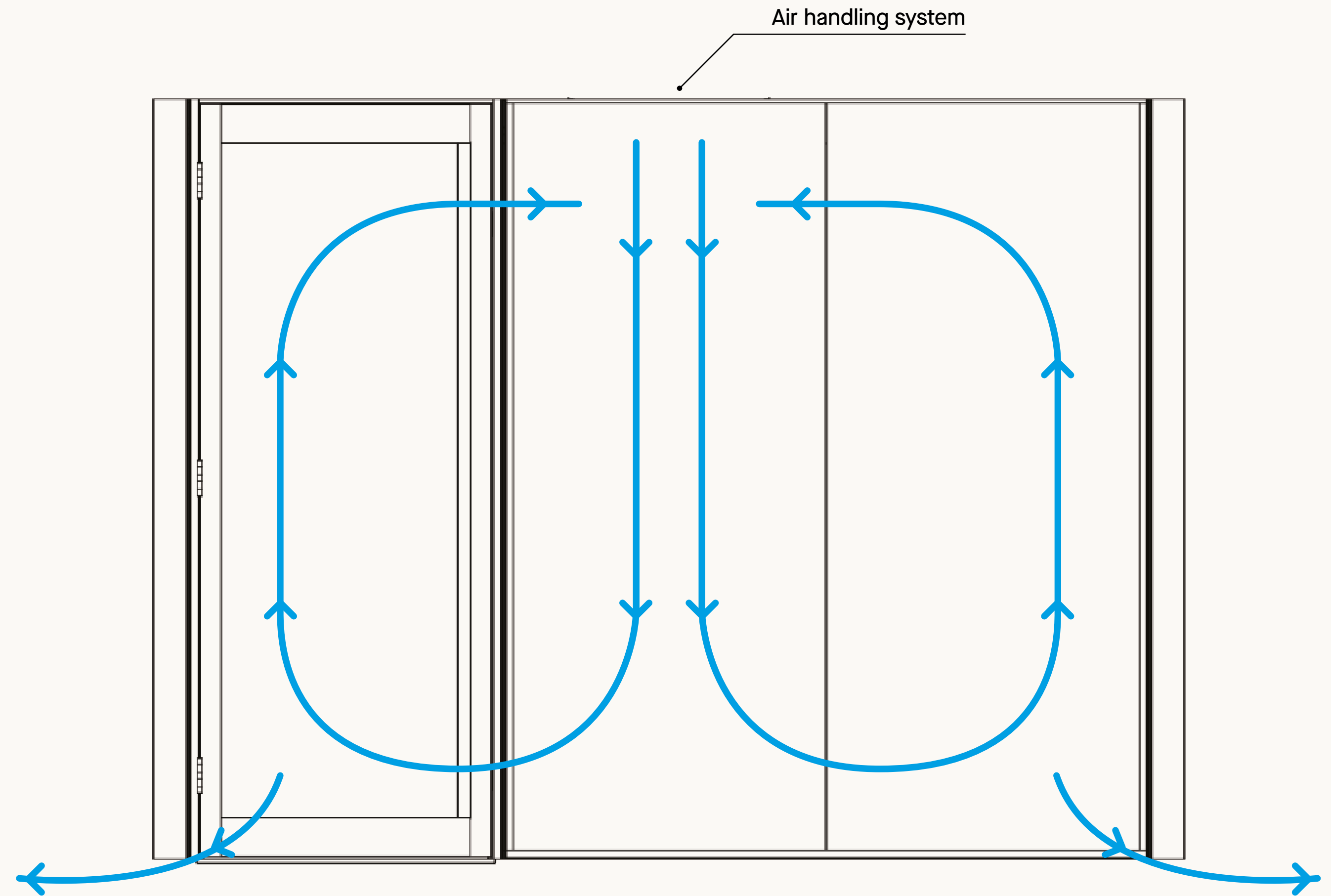

The flexibility to reconfigure

CellPod can be designed to create your perfect space, fully compliant with all workplace regulations and tailored to suit your needs. And just as business adapt and change, so too can CellPod.

Due to CellPods panel construction and modular design it can easily accommodate and reflect the needs of your business and people.

Reconfigurable: Like every business, things change. The modularity of CellPod enables it to be easily moved or reconfigured on demand.



Easy Installation:

The smallest Pod takes two people and two hours to install.



Plug and Play:

All Pods come with the ability to be used on the day of delivery and can easily be tailored to suit your AV and power requirements.

In detail



Telephone Booth
One person



Dimension:
Width: 3'9"
Depth: 3'9"
Height: 7'5"

Product Code:
CP2-1140-1140-FR

Airflow:
1no. Airflow Envirovent Silent MV 160/100
50 l/s (180 yds³/h)

Lighting:
— 1no. LED Downlight Natural White 4000k
— PIR controlled LED Lighting & Airflow
— up to 30 minute timer

AV capabilities:
Single Tier worksurface 41" AFF w/ Twin
Power Outlet 1x Twin USB A+C 30w 47.5"

Interior Walls:
Full fabric wall panels as standard

Glass Panels:
1/2" Laminated Acoustic, toughened to BS
EN12150)

Pivot Door:
1/2" Laminated Acoustic w/ magnetic closing
latch non-lockable

Ceiling:
Fixed Roof Only. Ecofon acoustic tile
with inset LED lighting and ventilation fans.
Tested to EN ISO354.

Study Booth
One person



Dimension:
Width: 8'7"
Depth: 5'10"
Height: 7'5"

Product Code:
CP2-1450-1140-FR

Airflow:
1no. Airflow Envirovent Silent MV 160/100
50 l/s (180 yds³/h)

Lighting:
— 2no. LED Downlight Natural White 4000k
— PIR controlled LED Lighting & Airflow
— up to 30 minute timer

Interior Walls:
Full fabric wall panels as standard

Glass Panels:
1/2" Laminated Acoustic, toughened to BS
EN12150

Pivot Door:
1/2" Laminated Acoustic w/ magnetic closing
latch non-lockable

Ceiling:
Fixed Roof Only. Ecofon acoustic tile
with inset LED lighting and ventilation fans.
Tested to EN ISO354.

Focus Pod
Suitable for two people

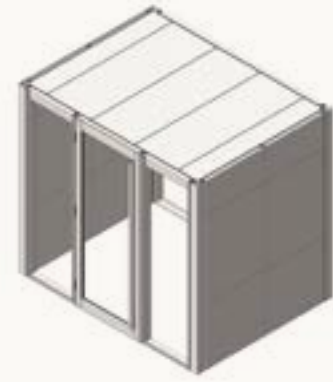

Dimension:
Width: 8'½"
Depth: 6'2"
Height: 7'5"

Product Code:
CP2-2450-1810-FR

Airflow:
1no. Airflow Envirovent Silent MV 350/125
96 l/s (330 Yds²/h)

Lighting:
— 1no. LED Luminaire Panel 600×600
Daylight 6000k
— PIR controlled LED Lighting & Airflow
– up to 30 minute timer.

AV capabilities:
Optional TV Mount to suit 42" - 70" c/w
Twin Power Outlet & Grommet

Interior Walls:
Full fabric wall panels as standard

Glass Panels:
½" Laminated Acoustic (Dry Jointed Glass
when more than one pane of glass)
toughened to BS EN12150

Pivot Door:
½" Laminated Acoustic w/ magnetic closing
latch non-lockable

Ceiling:
Fixed Roof Only. Ecofon acoustic tile
with inset LED lighting and ventilation fans.
Tested to EN ISO354.

Focus Pod
Suitable for two people

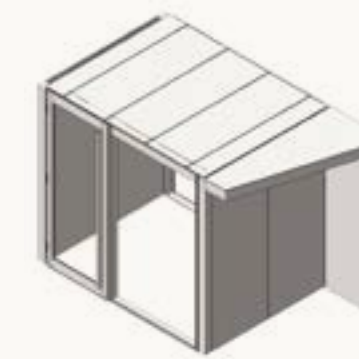

Dimension:
Width: 8'½"
Depth: 6'2"
Height: 7'5"

Product Code:
CPQ-7720-P

Airflow:
1no. Airflow Envirovent Silent MV 350/125
96 l/s (330 yds³/h)

Lighting:
— 1no. LED Luminaire Panel 600x600
Daylight 6000k
— Portico 2no. LED downlight natural
white 4000k w/ pir
— PIR controlled LED Lighting & Airflow
– up to 30 minute timer.

AV capabilities:
Optional TV Mount to suit 42" - 70" c/w
& Grommet

Interior Walls:
Full fabric wall panels as standard

Glass Panels:
½" Laminated Acoustic (Dry Jointed Glass
when more than one pane of glass)
toughened to BS EN12150

Pivot Door:
½" Laminated Acoustic w/ magnetic closing
latch non-lockable

Ceiling:
Fixed Roof Only. Ecofon acoustic tile
with inset LED lighting and ventilation fans.
Tested to EN ISO354.

Impromptu Meeting Room
Suitable for two people



Dimension:
Width: 8'½"
Depth: 5'8"
Height: 7'5"

Product Code:
CP2-2450-1410-FR

Airflow:
1no. Airflow Envirovent Silent MV 160/100
50 l/s (180 yds³/h)

Lighting:
— 1no. LED Luminaire Panel 600×600
Daylight 6000k
— PIR controlled LED Lighting & Airflow
– up to 30 minute timer

AV capabilities:
Optional TV Mount to suit 42"- 70" c/w
Twin Power Outlet & Grommet

Interior Walls:
Full fabric wall panels as standard

Glass Panels:
½" Laminated Acoustic (Dry Jointed Glass
when more than one pane of glass) tough-
ened to BS EN12150

Pivot Door:
½" Laminated Acoustic w/ magnetic
losing latch non-lockable

Ceiling:
Ecofon acoustic tile with inset LED lighting
and ventilation fans. Tested to EN ISO354.

Focus Pod
Suitable for two people

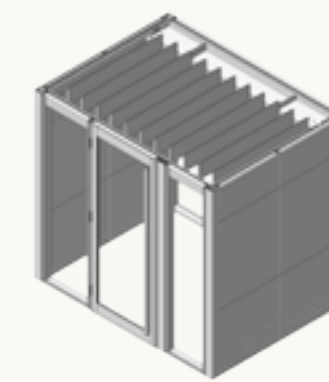

Dimension:
Width: 8'½"
Depth: 6'1"
Height: 7'5"

Product Code:
CPQ-7720-P

Airflow:
1no. Airflow Envirovent Silent MV 350/125
96 l/s (330 yds³/h)

Lighting:
— 1no. LED luminaire panel 1200x300
daylight 6000k
— PIR controlled LED Lighting & Airflow
– up to 30 minute timer

AV capabilities:
Optional TV Mount to suit 42"- 70" c/w
Twin Power Outlet & Grommet

Interior Walls:
Full fabric wall panels as standard

Glass Panels:
½" Laminated Acoustic (Dry Jointed Glass
when more than one pane of glass) tough-
ened to BS EN12150

Pivot Door:
½" Laminated Acoustic w/ magnetic
closing latch non-lockable

Ceiling:
Active Ceiling System, our patented roof
system (No.GB1718165.2).

Small Meeting Room
Suitable for four people

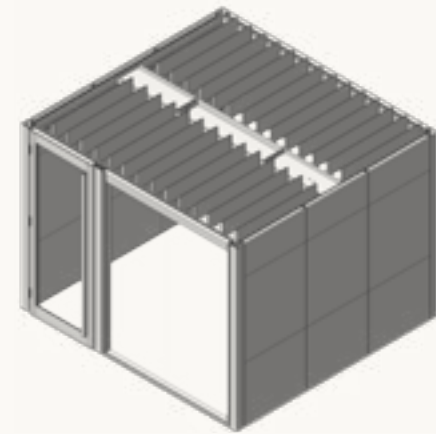

Dimension:

Width: 10'
Depth: 10'
Height: 7'5"

Product Code:
CPQ-7721-P

Airflow:

1no. Airflow Envirovent Silent MV 350/125
96 l/s (330 yds³/h)

Lighting:

- 1no. LED luminaire panel 1200x300 daylight 6000k
- PIR controlled LED Lighting & Airflow
- up to 30 minute timer

AV capabilities:

Optional TV Mount to suit 42"- 70" c/w
Twin Power Outlet & Grommet

Interior Walls:

Full fabric wall panels as standard

Glass Panels:

½" Laminated Acoustic (Dry Jointed Glass when more than one pane of glass)
toughened to BS EN12150

Pivot Door:

½" Laminated Acoustic w/ magnetic closing latch non-lockable

Ceiling:

Active Ceiling System, our patented roof system (No.GB1718165.2).

Small Meeting Room
Suitable for four people

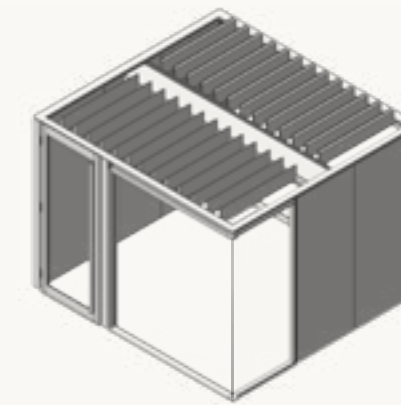

Dimension:

Width: 10'
Depth: 10'
Height: 7'5"

Product Code:
CPQ-7721-P

Airflow:

1no. Airflow Envirovent Silent MV 350/125
96 l/s (330 yds³/h)

Lighting:

- 1no. LED Luminaire Panel 600x600 Daylight 6000k
- PIR controlled LED Lighting & Airflow
- up to 30 minute timer

AV capabilities:

Optional TV Mount to suit 42"- 70" c/w
Twin Power Outlet & Grommet

Interior Walls:

Full fabric wall panels as standard

Glass Panels:

½" Laminated Acoustic (Dry Jointed Glass when more than one pane of glass)
toughened to BS EN12150

Pivot Door:

½" Laminated Acoustic w/ magnetic closing latch non-lockable

Ceiling:

Active Ceiling System, our patented roof system (No.GB1718165.2).

Small Meeting Room
Suitable for four people

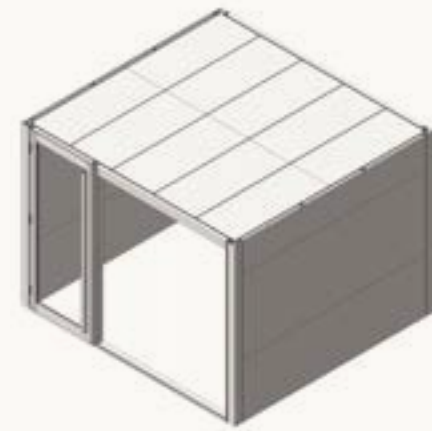

Dimension:
Width: 10'
Depth: 10'
Height: 7'5"

Product Code:
CP2-3050-2850-FR

Airflow:
1no. Airflow Envirovent Silent MV 350/125
96 l/s (330 yds³/h)

Lighting:
— 1no. LED Luminaire Panel 600×600
Daylight 6000k
— PIR controlled LED Lighting & Airflow
– up to 30 minute timer

AV capabilities:
Optional TV Mount to suit 42”- 70” c/w
Twin Power Outlet & Grommet

Interior Walls:
Full fabric wall panels as standard

Glass Panels:
½" Laminated Acoustic (Dry Jointed Glass
when more than one pane of glass)
toughened to BS EN12150

Pivot Door:
½" Laminated Acoustic w/ magnetic closing
latch non-lockable

Ceiling:
Fixed Roof Only. Ecofon acoustic tile
with inset LED lighting and ventilation fans.
Tested to EN ISO354.

Medium Meeting Room
Suitable for six people

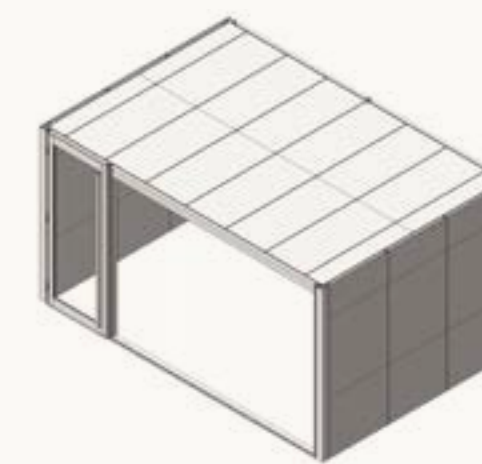

Dimension:
Width: 14'
Depth: 9'4"
Height: 7'5"

Product Code:
CP2-4250-2850-FR

Airflow:
2no. Airflow Envirovent Silent MV 350/125
96 l/s (330 yds³/h)

Lighting:
— 2no. LED Luminaire Panel 600×600
Daylight 6000k
— PIR controlled LED Lighting & Airflow
– up to 30 minute timer

AV capabilities:
Optional TV Mount to suit 42”- 70” c/w
Twin Power Outlet & Grommet

Interior Walls:
Full fabric wall panels as standard

Glass Panels:
½" Laminated Acoustic (Dry Jointed Glass
when more than one pane of glass)
toughened to BS EN12150

Pivot Door:
½" Laminated Acoustic w/ magnetic closing
latch non-lockable

Ceiling:
Fixed Roof Only. Ecofon acoustic tile
with inset LED lighting and ventilation fans.
Tested to EN ISO354.

Medium Meeting Room
Suitable for six people

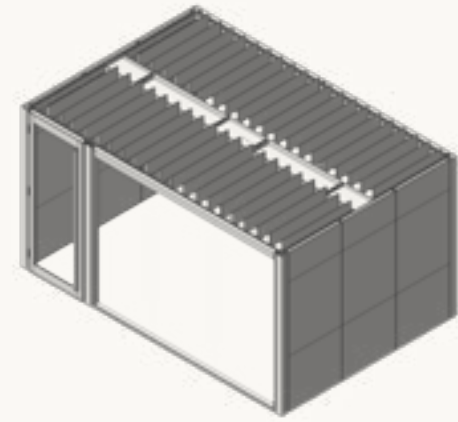

Dimension:
Width: 14'
Depth: 9'4"
Height: 7'5"

Product Code:
CP2-4250-2850-OR

Airflow:
2no. Airflow Envirovent Silent MV 350/125
96 l/s (330 yds³/h)

Lighting:
— 2no. LED luminaire panel 1200x300
daylight 6000k
— PIR controlled LED Lighting & Airflow
- up to 30 minute timer

AV capabilities:
Optional TV Mount to suit 42"- 70" c/w
Twin Power Outlet & Grommet

Interior Walls:
Full fabric wall panels as standard

Glass Panels:
½" Laminated Acoustic (Dry Jointed
Glass when more than one pane of glass)
toughened to BS EN12150

Pivot Door:
½" Laminated Acoustic w/ magnetic closing
latch non-lockable

Ceiling:
Active Ceiling System, our patented roof
system (No.GB1718165.2).

Large Meeting Room
Suitable for eight people

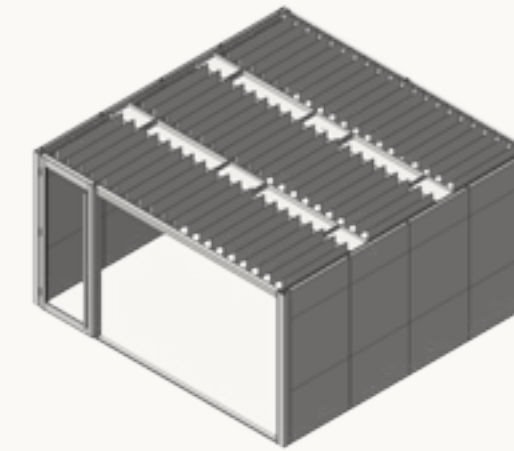

Dimension:
Width: 14'
Depth: 14'
Height: 7'5"

Product Code:
CP2-4250-4250-OR

Airflow:
4no. Airflow Envirovent Silent MV 350/125
96 l/s (330 yds³/h)

Lighting:
— 4no. LED luminaire panel 1200x300
day light 6000k
— PIR controlled LED Lighting & Airflow
- up to 30 minute timer

AV capabilities:
Optional TV Mount to suit 42"- 70" c/w
Twin Power Outlet & Grommet

Interior Walls:
Full fabric wall panels as standard

Glass Panels:
½" Laminated Acoustic (Dry Jointed Glass
when more than one pane of glass)
toughened to BS EN12150

Pivot Door:
½" Laminated Acoustic w/ magnetic closing
latch non-lockable

Ceiling:
Active Ceiling System, our patented roof
system (No.GB1718165.2).

Large Meeting Room
Suitable for eight people

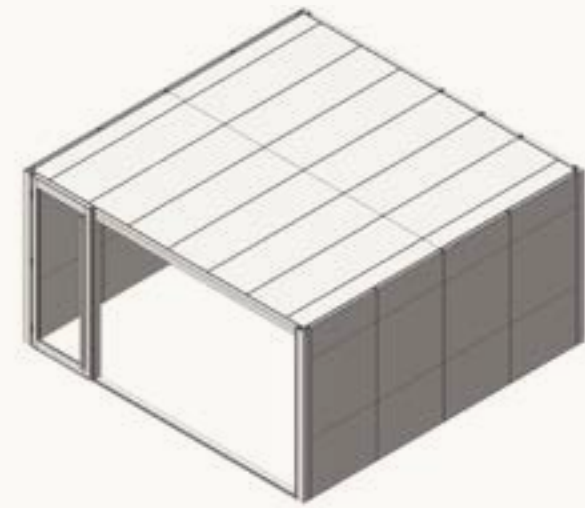

Dimension:
Width: 14'
Depth: 14'
Height: 7'5"

Product Code:
CP2-4250-4250-FR

Airflow:
1no. Airflow Envirovent Silent MV 350/125
96 l/s (330 yds³/h)

Lighting:
— 4no. LED luminaire panel 1200x300
day light 6000k
— PIR controlled LED Lighting & Airflow
- up to 30 minute timer

AV capabilities:
Optional TV Mount to suit 42"- 70" c/w
Twin Power Outlet & Grommet

Interior Walls:
Full fabric wall panels as standard

Glass Panels:
½" Laminated Acoustic (Dry Jointed
Glass when more than one pane of glass)
toughened to BS EN12150

Pivot Door:
½" Laminated Acoustic w/ magnetic closing
latch non-lockable

Ceiling:
Ecofon acoustic tile with inset LED lighting
and ventilation fans. Tested to EN ISO354.

Large Meeting Room
Suitable for 12 people

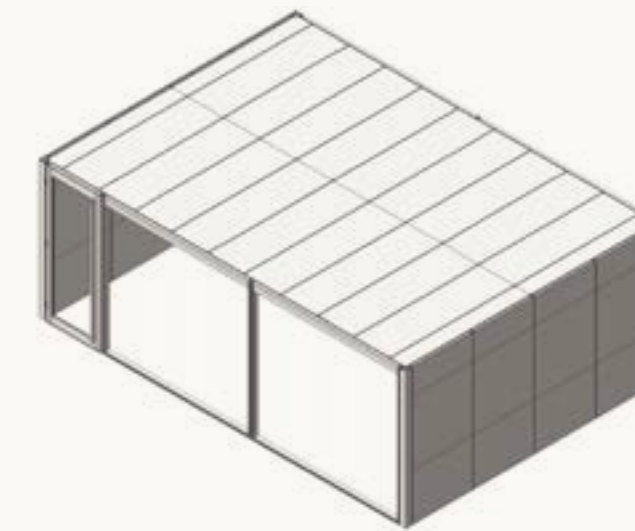

Dimension:
Width: 19'10"
Depth: 14"
Height: 7'5"

Product Code:
CP2-6050-4250-FR

Airflow:
6no. Airflow Envirovent Silent MV 350/125
96 l/s (330 yds³/h)

Lighting:
— 6no. LED luminaire panel 600x600 day
light 6000k
— PIR controlled LED Lighting & Airflow
- up to 30 minute timer

AV capabilities:
Optional TV Mount to suit 42"- 70" c/w
Twin Power Outlet & Grommet

Interior Walls:
Full fabric wall panels as standard

Glass Panels:
½" Laminated Acoustic (Dry Jointed
Glass when more than one pane of glass)
toughened to BS EN12150

Pivot Door:
½" Laminated Acoustic w/ magnetic closing
latch non-lockable

Ceiling:
Ecofon acoustic tile with inset LED lighting
and ventilation fans. Tested to EN ISO354.

A world of color



Paint Finishes

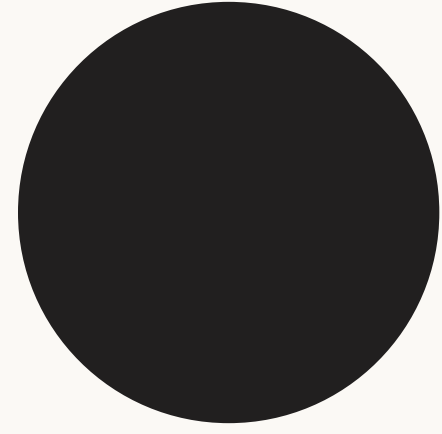

Black

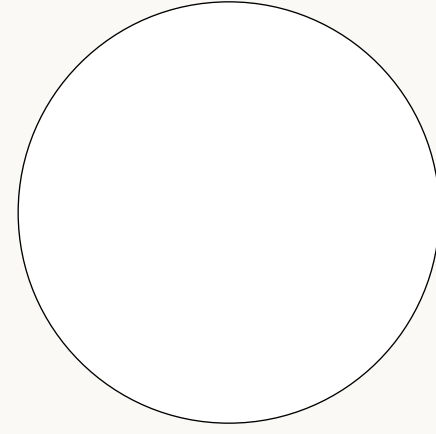

White

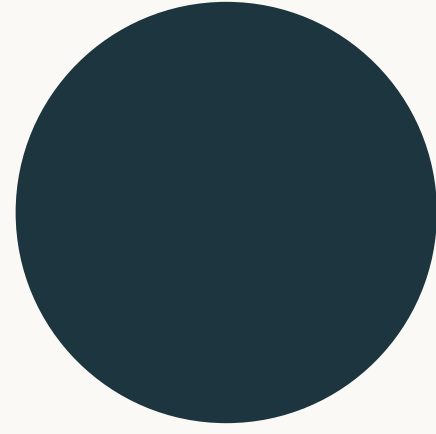

Ocean Blue
RAL 5020

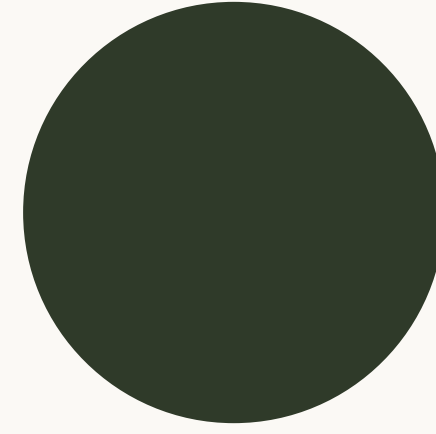

Dark Green
RAL 6020

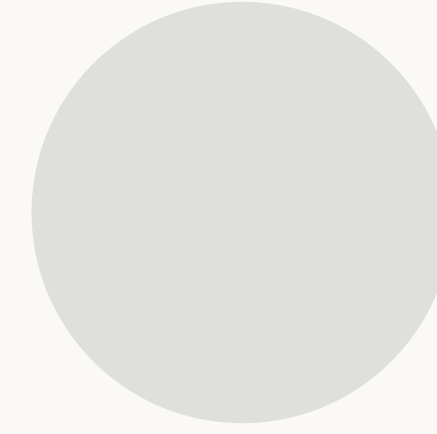

Silk Gray
RAL 7044

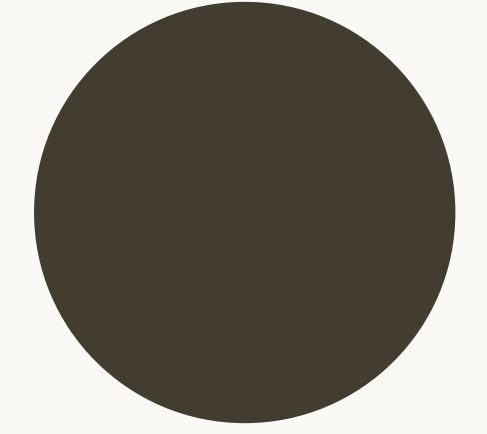

Putty
RAL 7006

TFL / MFC



Black

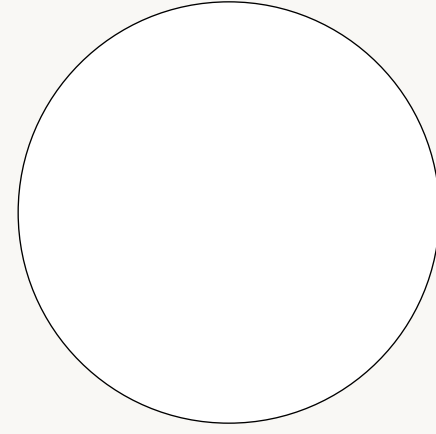

White



Oak



Maple

Fabrics



Camira
Blazer Napier

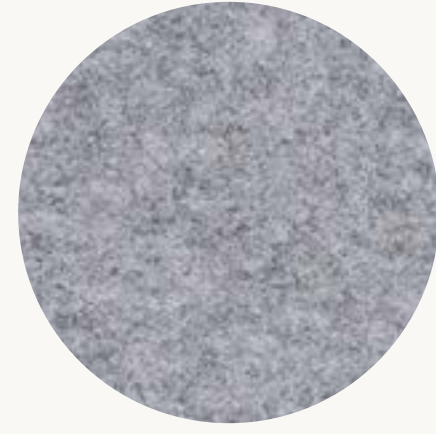

Camira
Blazer Silverdale



Camira
Blazer Surrey



Camira
Blazer Silcoates



Camira
Blazer Dartmouth



Camira
Blazer Edinburgh



Camira
Blazer Plymouth

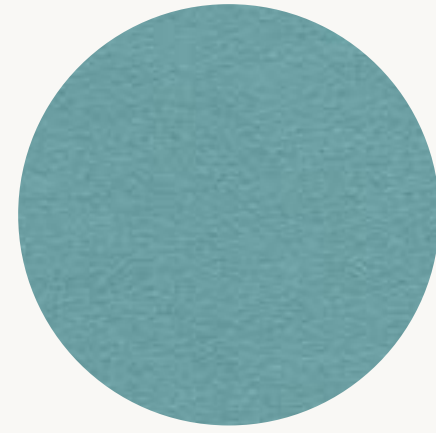

Camira
Blazer Woodcroft



Camira
Blazer Abertay



Camira
Blazer Cardiff

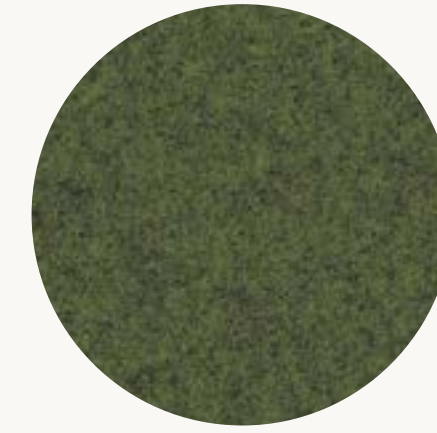

Camira
Blazer Camphill



Camira
Blazer Hull



Camira
Blazer Handcross



Camira
Blazer Eynesbury

Where to find us:

Global Headquarters

Altham Business Park
Accrington, Lancashire
BB5 5YE
United Kingdom

London

Back Hill
Farringdon
London EC1R 5EN
United Kingdom

Birmingham

Sovereign Hall
Frederick Street
Birmingham B1 3HE
United Kingdom

Corporate Headquarters

4111 N. Jerome Road
Maumee, OH
43537
United States

New York

3 East 28th St, 9th Floor
New York, NY
10016
United States

Chicago

222 Merchandise Mart Plaza
Floor 11, Suite 1112
Chicago, IL
60654
United States

Hong Kong

Suites 2508-2509
K11 Aterlier
728 King's Road
Quarry Bay
Hong Kong

Bengaluru

No. 295 & 296, 3rd Floor
100 Feet Road
Indiranagar
Bengaluru 560038
India

Dubai

Dubai Marina Plaza
Floor 22
Suite 2203
P.O. Box 116888
Dubai